

## ACCESS INFORMATION for the exhibition of MELT: Counting Feelings (Opening: April 14th, 17h – 20h)

### Venue:

Art & Textiles Library  
216 Faculty of Humanities Main Building  
Building 2/ Block B  
2nd upper floor  
Room 2.214  
(Entrance/Access via secretary's office room 2.213)

### Address:

Gronewaldstraße 2  
50931 Cologne, Germany

### Google Maps pin to Building 2/ Block B:

<https://goo.gl/maps/vrKjqK2R5sE7jgma6>

### Location map tool of the University of Cologne:

<https://lageplan.uni-koeln.de/#!216b>

### Contact information janitor (borrowing the restroom/elevator key):

Tel: +49 221 470 – 4615

### Contact information Access Facilitator Rubina Ünzelmann (She can be contacted regarding accessibility, directions, a pick-up, etc.)

E-Mail: [ruenzelm@smail.uni-koeln.de](mailto:ruenzelm@smail.uni-koeln.de)

Contact number: +4915789151895

### Exhibition Abstract:

Join us this April 14th from 17h at the [Fachbibliothek Kunst & Textil](#) for the opening of [MELTs](#) exhibition „Counting Feelings“. MELT’s interactive installation unfolds possibilities for lovingly engaging the knowledges of Trans\* and autistic people when it comes to data about our lives. As NRW media arts fellows, [MELT spent one semester at the University of Cologne](#) and collaborated with Konstanze Schütze. During this time MELT held three workshops with Trans\* and disabled participants on the topic of data for Trans\* and disabled lives.

Counting Feelings unseats data practices that disembodify and disconnect from the people who any data is about. Moving from a politics that asserts ‘nothing about us without us’ the works in this installation celebrate Trans\* and autistic authorship, embodied data practices and dreaming. Following practices that focus on embodiment, MELT engages the senses throughout the exhibition space. Modifications of sensory inputs like light, touch, weight, reading and play permeate the works in the space and offer practices of rest, touch and connectivity over time as modes of approaching the exhibition.

Installed within the interactive installation are three distinct works. ***Beginning nodes for revolutionary data practices or groundwork for reimagining data*** consists of a grid like floor

installation with statements emerging from workshops with Trans\* and disabled participants considering our engagements with data; these statements entangle with clay data points that visitors are invited to move around to express interest in the statements and to play and stim with. **Pop up Disabled Data Center** is a series of stitched together fabric and plastic planes that shelter visitors. The work prompts reading with accessible language practices like embroidered braille and brings visitors into a prompt for sharing what kind of data they carry with themselves. These data sets shift and change what data is understood to be – no material or quantifiable requirements are enumerated within these sets – included alongside are data sets that have been collaboratively built by Counting Feelings workshop participants. **Data Set of Weight** is a heavy blanket weighing down data feelings on our bodies. Consisting of a weighted stitched blanket filled with stones and other heavy materials, this data set wraps around visitors as a thick warm blanket.

During the opening there will be time to experience the exhibition and to meet MELT (Ren Loren Britton & Iz Paehr).

The exhibition has been realized with the work and support of Anna Sprenger, the team of the Library for Arts and Textiles, Sandra D'ujanga and Rubina Ünzelmann-Balotsch.

*The project is kindly funded by the Ministry of Culture and Science of the State of North Rhine-Westphalia in the [Media Art Fellows program](#).*

### **Duration of the exhibition and visiting hours:**

18.04. – 11.05.23, Tue, Wed, Thurs, 10h – 16h

### **Access Information Overview**

The **language** of the exhibition will be English (partial translations into German possible). Translation into sign language will not be available. (Vegan) **Snacks and drinks** will be provided during the exhibition opening and various/vegan lunch/dinner options are available on the main street nearby (Dürener Straße). We ask visitors to use little or no **perfume/scent** etc. before the exhibition. **Children** are welcome (A parent-child room is located in Building 3/ Block C Room 0.330). A **relaxation room** is available in the building in Herbert-Lewin-Straße in room 2.10.

Paved steps/paved ramp must be used to reach the level to the entrance to Building 2/Block B. The entrance to Building 2/Block B of the Main Building is **wheelchair accessible** as well as level and has a wheelchair accessible switch to open the entrance door. Direct access to the library on the 2nd floor is at ground level. There is a **wheelchair accessible bathroom** on the ground floor of the main building. **Gender-neutral restrooms** are available in the basement of Building 2/Block B.

The library is equipped with seating, as are other seminar rooms that could be used during the workshop. The seats have backrests but no armrests. Furthermore, the lighting in the library consists of bright neon/fluorescent lights, which can be switched off in the main room if necessary (the secretary's office must remain properly lit). No windows can be opened in the library. The entire second floor of Building 2/Block B has an internal ventilation system that produces a monotonous noise. This can be temporarily turned off in the library.

If you would like to attend the exhibition and/or have additional access needs, please email us. Let us know what you need to participate. Email us at: [asprenger96@gmail.com](mailto:asprenger96@gmail.com)

The following pages contain detailed information regarding orientation, transportation, building access and elevators, signage, parking, restrooms, relaxation room as well as parent-child room.

# Information for orientation

Map of the Faculty of Humanities (event building is marked in red and has a stripy outline):

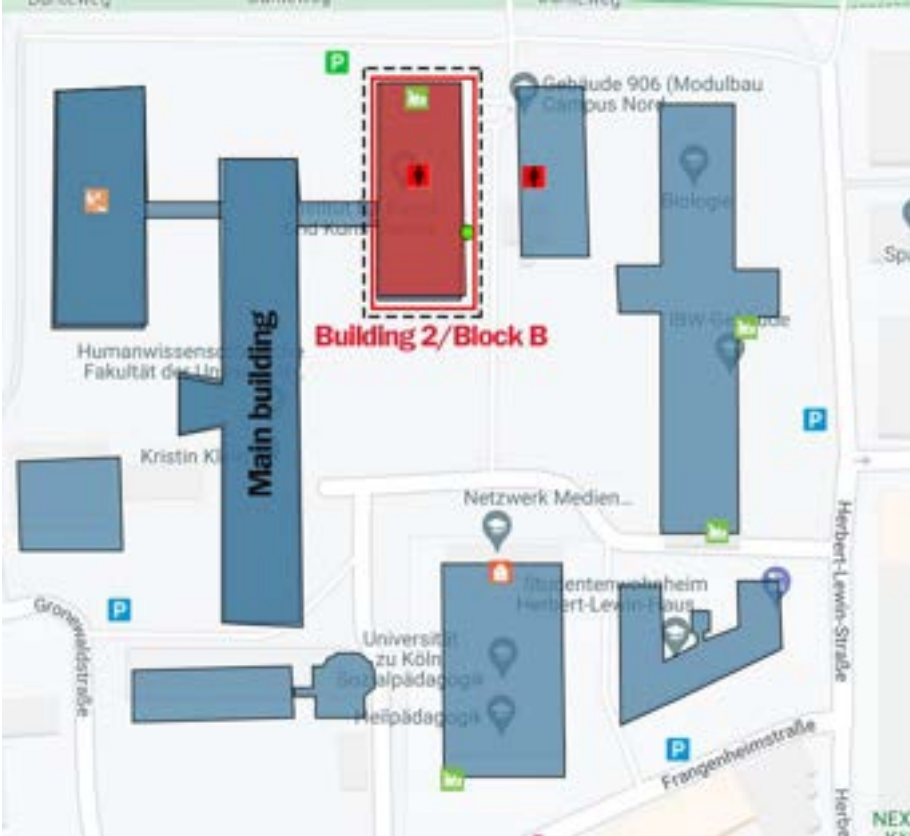

Overview main building inside (event building is marked red and has a stripy outline):



## Nearest Tram and Bus Station:

Universitätsstr. (600m)

Google Maps Pin: <https://goo.gl/maps/EyctNmZzeLgTZbyCA>

Bus: 109, 142, 172

Tram: 1, 7, 9, E

The station is above ground and has no steps.

## The Route to the Faculty of Humanities

The two main routes to the building (marked in a [black dotted line](#) and a [pink line](#)) from the Tram and Bus station:



There is partially unpaved ground on the path from the Bus/Tram station to the main building, which can be muddy/slippery depending on the weather (Danteweg).

## Access to the building (stairs to the art department)

Stairs or the elevator can be used to reach the second floor. There will be a temporary sign that will point you to the library.

**Appearance and location of the elevator for Building 2/ Block B:**



**Location of the library in Building 2/Block B:**

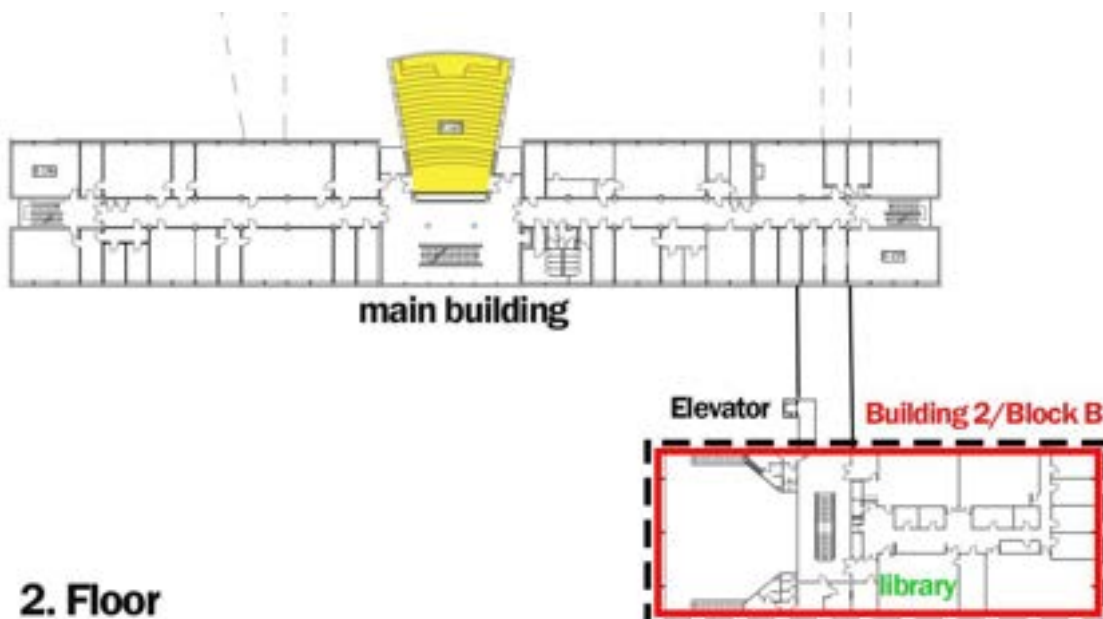



## Parking:

The following map shows four public parking areas (parking-meter) around the Humanities Department (marked in red with an outline):



## Restrooms:

There is a wheelchair accessible restroom on the first floor of the main building. The restroom is equipped with a toilet and a shower. The WC is accessible with the Euro disabled WC key, which can also be borrowed from the janitor of this building.

There are gender-separated toilets both on the first floor and on the second floor of the main building. A gender neutral bathroom can be found in the basement of building 2/Block B right across from the library book check out station of the Humanities Department.



Location of toilets on the Ground Floor and 1st floor:



Ground floor

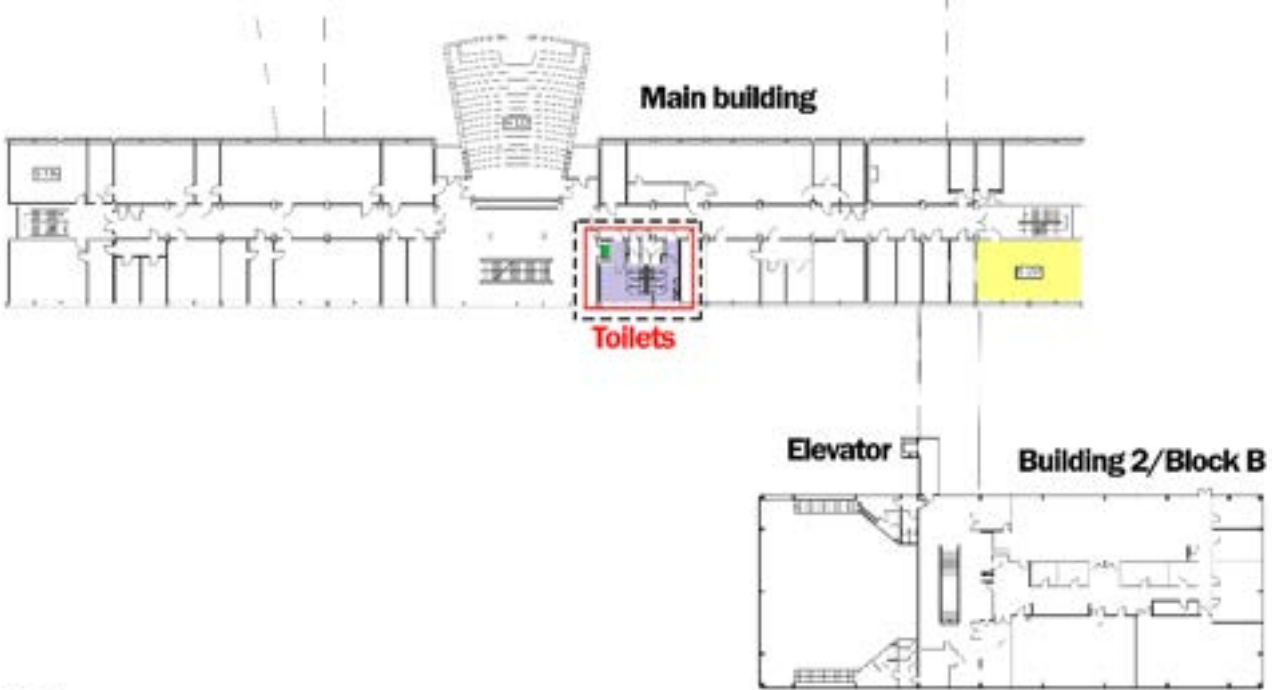

1. Floor



Location of gender-neutral toilets in the basement of Block B and the sign that accompanies the gender-neutral bathrooms at the University:

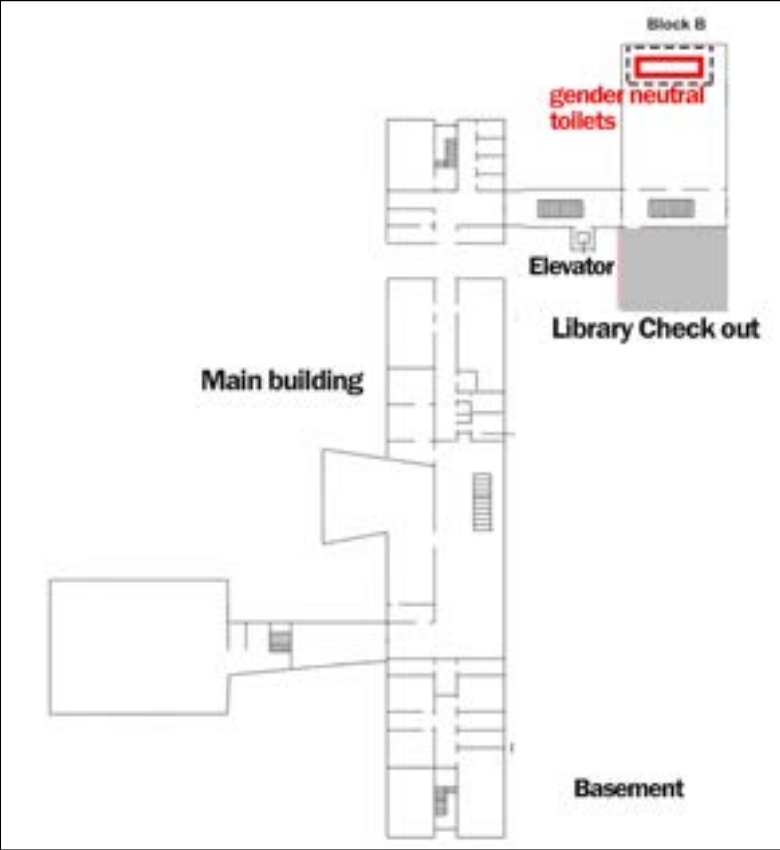

**WC**  
für alle  
Geschlechter



### Relaxation room:

The relaxation room is located in the building in Herbert-Lewin-Straße in room 2.10. Here you will find a couch, a beanbag and a lift. The room can be accessed with the Euro disabled WC key, which can also be borrowed from the janitor.



### Parent-child room:

Room 0.330 in Building 3/Block C (first floor)

Contact: Ms. Vildan Cetin (vildan.cetin@uni-koeln.de): Phone 0221-470-3136

Location of Building 3/Block C:

